

DRAWING (mm)

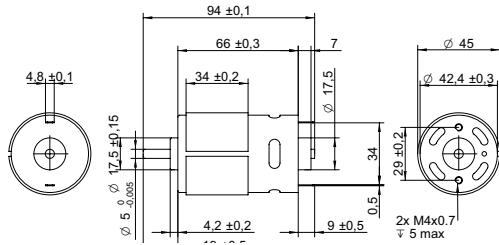

PHOTO



MODEL NO. DESIGNATION

MODEL	-	BRUSH TYPE	-	ELECTRONIC COMPONENT
		C: Carbon brush M: Metal brush		C: Capacitor V: Varsitor

Example: 775-9008F-CC

OPTIONS POWER SUPPLIES



● C = customizations are offered on demand even for smaller quantities. Typical customizations are indicated with a green dot at column end. Please contact us for any customization request.

MOTOR DATA C

Model number		775-9008F-CC	775-9009F-C-CC	775-8013F-C-CC	775-5520F-CC	
Diameter	mm	45	45	45	45	
Length	mm	66	66	66	66	
Nominal voltage	V	7.2	12	18	24	●
No load current	A	3.2	2.8	3	1.7	●
Nominal current	A	20.1	21.1	15.8	10.7	●
Start/Stall current	A	110	140	110	68	●
No load speed	rpm	15000	21000	22000	21000	●
Nominal speed	rpm	12000	18000	19000	18000	●
Nominal torque	mNm	80	100	100	94	●
Start/Stall torque	mNm	510	810	840	710	●
Nominal power	W	100	190	200	180	●
Efficiency	%	72	77	70	71	

COMMON MOTOR DATA C

Shaft diameter	mm	5		●
Number of pole pairs		1		
Number of commutator segments		5		
Weight	g	480		
Service life	hrs	500 to 1000		
Operating temperature	°C	-10 to +60		●
Housing material		Galvanized steel		
Shaft material		High-carbon steel		●
Magnet material		Ferrite		
IP rating		IP40		
Motor insulation class		Level A		●

MOTOR DATA GRAPH - 775-9008F-CC

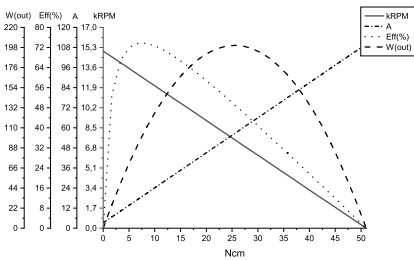

MOTOR DATA GRAPH - 775-9009F-C-CC

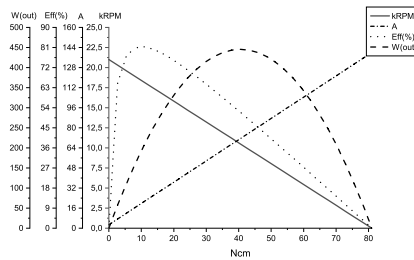

MOTOR DATA GRAPH - 775-8013F-C-CC

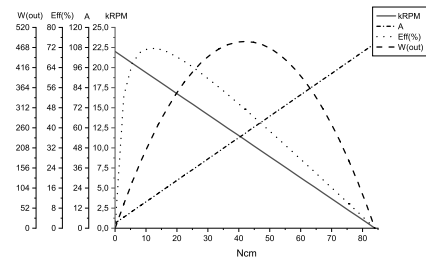

MOTOR DATA GRAPH - 775-5520F-C-CC

